

OPERATING SYSTEM

Available with Windows 10 Home: Gaming is better than ever on Windows 10, with games in 4K, DirectX 12 and streaming your gameplay.*_



BREAKING NEW BENCHMARKS. AGAIN.

The world's most powerful laptop just got an upgrade. With extraordinary desktop-level processing power, CPU and GPU upgradability, advanced cooling and a premium, revolutionary design, the Alienware Area-51m R2 is a true desktop-gaming experience in the form of a laptop.



UNPRECEDENTED POWER & PERFORMANCE

New firsts in power: The Area-51m R2 features a host of firsts for peak performance and power. It's our first-ever laptop to feature overclockable 10th Gen Intel® Core™ i9K desktop processors, support for up to 125W of power, and 10-core desktop CPU options, giving it a whole new level of compute power versus other gaming laptops.

Greater graphics and gameplay: Experience vivid, uninterrupted gaming and faster frame rates during high-powered gameplay thanks to overclockable NVIDIA® GeForce® RTX™ graphics or, for the first time in the Area-51m R2, AMD Radeon™ graphics. Now featuring a new 360Hz FHD display option, you can expect the smoothest fast-paced gameplay and the best 17" front-of-screen experience imaginable.

Massive memory: The Area-51m R2 is also Alienware's first gaming laptop to support up to 64GB of DDR4 memory at 2933Mhz or 32GB of DDR4 XMP memory at 3200Mhz. This ensures enough RAM for even the most resource-intensive workloads and tasks, making it ideal for gaming developers, content creators and multitasking streamers.

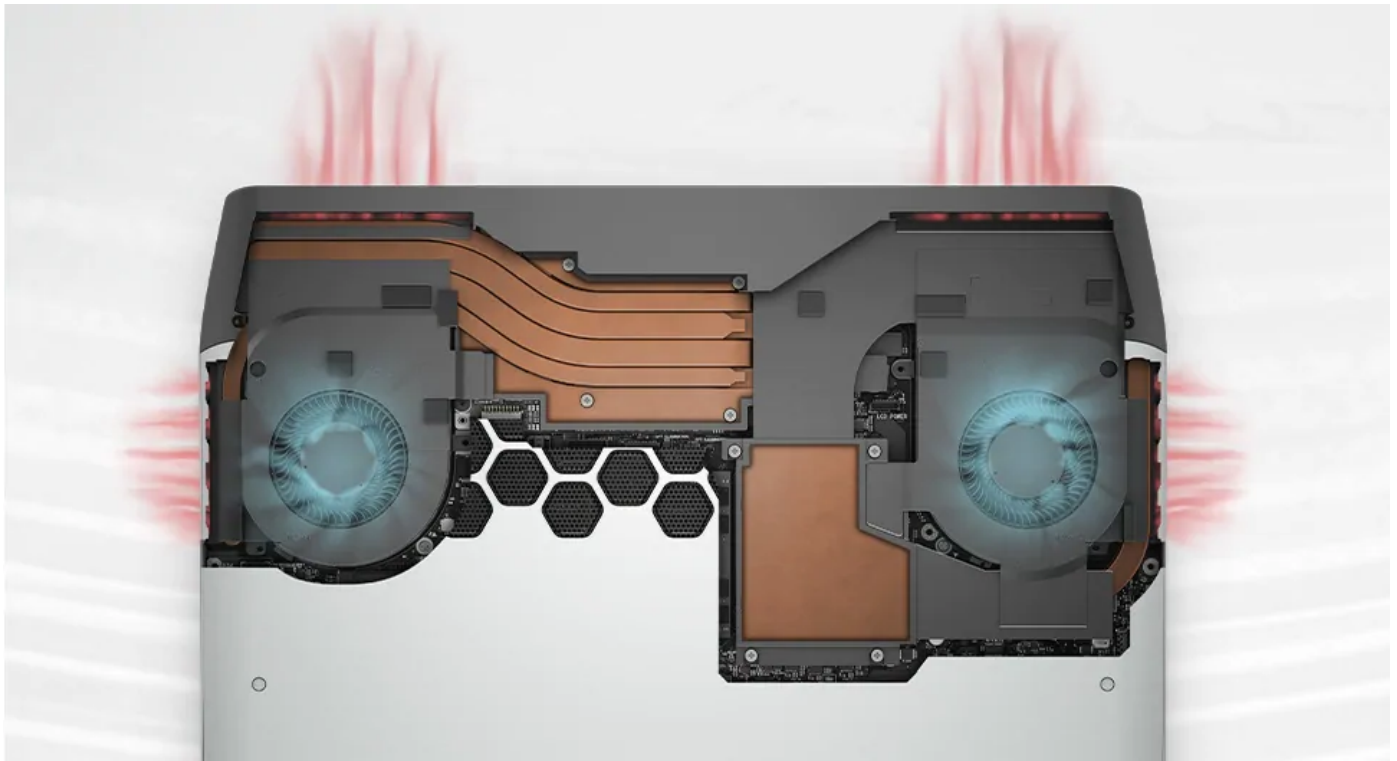

ADVANCED COOLING & PERFORMANCE UPDATES

The Area-51m R2 features all-new engineering efforts to increase thermal capacity and performance. It now offers three different cooling solutions and power management techniques based on your graphics selection. Every one of these new features is engineered to enable the higher wattage requirements of our new updates and their respective overclocking expectations.

Hyper-efficient voltage regulation is a technology developed by the Alienware engineering team to enable maximum performance for extended amounts of time with safeguarded thermal conditions. For the first time ever in a gaming laptop, the Area-51m R2 features a 12-phase graphics voltage regulation option, ensuring Alienware's highest sustained graphics performance ever.

Vapor chamber cooling technology uses advanced methods to efficiently dissipate heat from extreme-performance graphics options. These chambers utilize the phase-changing nature of liquid to transfer heat more effectively than a solid piece of metal or copper heat pipes. Vapor chambers are also more versatile than copper heat pipes in that they can be spread evenly across an entire chip that needs to be cooled.

10% larger fan blades than the previous generation of the Area-51m R2 are available on both the AMD® and NVIDIA® options, ensuring high-performance graphics cards receive enhanced cooling when the action heats up.

ICONIC DESIGN WITH A MODERN EDGE

The Alienware Area-51m R2 raises the bar for innovative engineering with its game-changing design. The visual identity was inspired by our early industrial designs, marking a return to form while taking cues from our original roots.

The futuristic design of the Area-51m R2 reflects the diverse, evolving nature of gamers everywhere, incorporating high contrast, performance-focused engineering with blended bone lines, angled sections, bold lighting, and celebrated thermals.

Bold lighting: The latest evolution of AlienFX lighting features a striking ring of light at the rear of the system, highlighting system performance while maintaining ultimate customizability.

Narrow bezel: The Area-51m R2 features a drastic reduction of screen borders thanks to its narrow bezel with a three-knuckle hinge. This reduces the mass and maintains a strong connection to the base.

Premium shell: The unique magnesium alloy exoskeleton enables enhanced rigidity, while reducing overall chassis

weight. This allows more space for high-performance components inside the machine.

Dual color options: Gamers can choose between a new, futuristic look in Lunar Light or Dark Side of the Moon, a darker, more traditional appearance.



GAME-ENHANCING FEATURES

Advanced keyboard: With the Alienware TactX keyboard, N-key rollover technology enables over 108-key commands for maximum actions per minute and 1.7mm of key travel allows for rapid response for any keystroke. Per-key AlienFX lighting delivers customizable lighting profiles, while programmable macro keys let you create gaming and non-gaming shortcuts for over 150 game titles.

2.5Gbps Killer Ethernet: The Area-51m R2 features up to 2.5Gbps of bandwidth over a Killer E3000 Ethernet port providing gamers up to 2.5x the amount of bandwidth available in common, wired Ethernet, connections for blazing-fast file transfers.

Thunderbolt™ Type-C port: This multi-use port is ready to be used as a USB 3.1 port, offering 10Gbps of data transfer, a Thunderbolt™ connection capable of 40Gbps, or even a DisplayPort enabling various monitors supporting the DisplayPort protocol.

Enhanced storage: The Area-51m R2 can support up to 4x SSDs for massive storage and redundancy options with RAID5 capabilities, giving you added performance and security to ensure your files are always safe and available.

Hear every battle cry: Experience every sound with best-in-class speakers for a laptop. High-end headphone support delivers outstanding fidelity while Far Field Audio improves microphone performance.



ADVANCED EYE TRACKING

The next generation Tobii eye tracking adds a completely new form of immersion to your game. Smaller sensors with wake capabilities enable features and sensitivity to track head pose, face ID, presence, fine gaze and eye

position.

Enhanced interactions: UI elements fade when not making eye contact so you can get deeper into the game. Characters know when you're looking at them and will respond accordingly.

New tracking tools: Learn, train and improve using eye tracking-enabled tools designed to measure your mini map awareness and help you learn when to pay attention to the clock.

Software support: Show viewers where you're looking while streaming your favorite game. Tobii Ghost software supports all major streaming platforms and software.

Twitch-ready: Toggle between visualizations like heatmaps, shadow, and spotlight using our extension. You no longer need to move your mouse to show viewers what you're talking about, just glance at it.

NEW ALIENWARE COMMAND CENTER



CALIBRATE YOUR CONTROLS

Now you have control over your hardware and software environments. Not only can you tailor the hardware for each and every game you play, you can personalize the space and setup to make your software look and feel precisely the way you want it, without interfering with your gameplay or other activities.

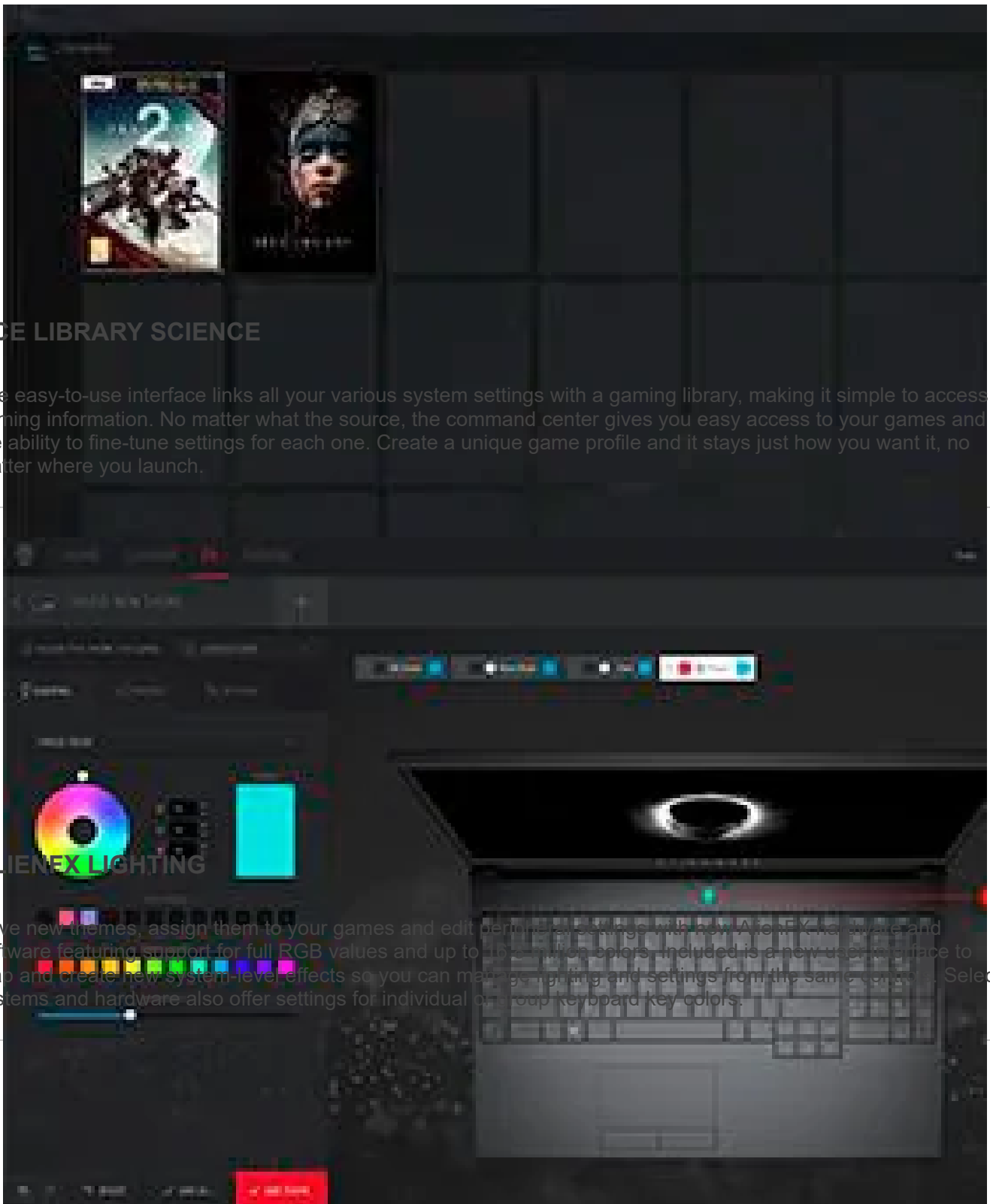

GAME LIBRARY SCIENCE

The easy-to-use interface links all your various system settings with a gaming library, making it simple to access gaming information. No matter what the source, the command center gives you easy access to your games and the ability to fine-tune settings for each one. Create a unique game profile and it stays just how you want it, no matter where you launch.

ALIENFX LIGHTING

Save new themes, assign them to your games and edit device-level settings with new AlienFX hardware and software featuring support for full RGB values and up to 16.8 million colors. Included is a new user interface to map and create new system-level effects so you can manage lighting and settings from the same control. Select systems and hardware also offer settings for individual or group keyboard key colors.



ALIENWARE MOBILE CONNECT

Alienware Mobile Connect creates an advanced, complete, and wireless integration between your PC and iOS or Android smartphone.

Enjoy your iOS or Android smartphone functionality through your Alienware PC's mouse, keyboard, and touch screen.

Make or take calls, send and receive text messages, access your contacts, get mobile notifications, and, on Android, mirror your phone's screen onto your PC for interactive engagement with any of your smartphone apps.

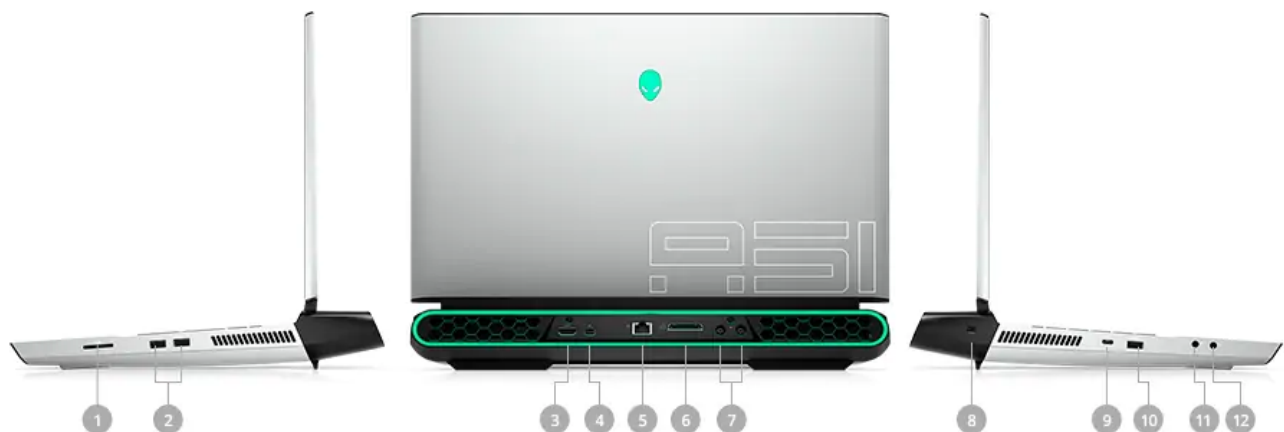

PORTS & SLOTS

1. Media Card Reader | 2. (2x) Type-A USB 3.2 Gen 1 Port | 3. HDMI 2.0 Output with HDCP 2.2 Output Port (Supports direct drive VR interfaces) | 4. Mini DisplayPort™ 1.4 Output Port (supports NVIDIA® G-Sync®) | 5. RJ-45 Killer™

Ethernet E3000 10/100/1000Mbps/2.5Gbps Port | 6. Alienware Graphics Amplifier Port | 7. Dual DC Power Inputs | 8. Wedge-shaped lock slot (cable and lock sold separately) | 9. Thunderbolt™ 3 Port (supports USB 3.2 Gen 2 and DisplayPort 1.2) | 10. Type-A USB 3.2 Gen 1 Port with Powershare Technology | 11. Audio Out 1/8" Port (Compatible with inline mic headset) | 12. Global Headset Port



DIMENSIONS & WEIGHT

1. Height: Front 1.089" (27.65 mm), Peak 1.7" (44 mm), Rear 1.25" (31.8 mm) | 2. Width: 15.85" (402.6 mm) | 3. Depth: 12.565" (319.14 mm)

Entry SKU weight maximum: 9.04 lb (4.1 kg)*

Upsell SKU Weight maximum: 10.4 lb (4.7 kg)*